

PROJECT INFORMATION

OWNER:
JACK HANOVER

DRAWINGS BY:
ECCO DESIGN INC.
7413 GREENWOOD AVE N
SEATTLE, WA 98103
206-706-3937

SITE ADDRESS:
6460 E MERCER WAY
MERCER ISLAND, WA 98040

PARCEL NUMBER:
292600-0010

BODY OF WATER:
LAKE WASHINGTON

LEGAL DESCRIPTION:
GREGORY ADD & AN UND 1/4 INT IN COMMUNITY
TR AKA PARCEL A OF MERCER ISLAND LN
REVISION NO 94-0118 REC NO 9403259005
PLAT LOT: 1

PROJECT DESCRIPTION:
REPAIR AN EXISTING PIER BY RE-FRAMING,
RE-DECKING WITH GRATED DECKING, AND
SLEEVING NINE PILES.

VICINITY MAP

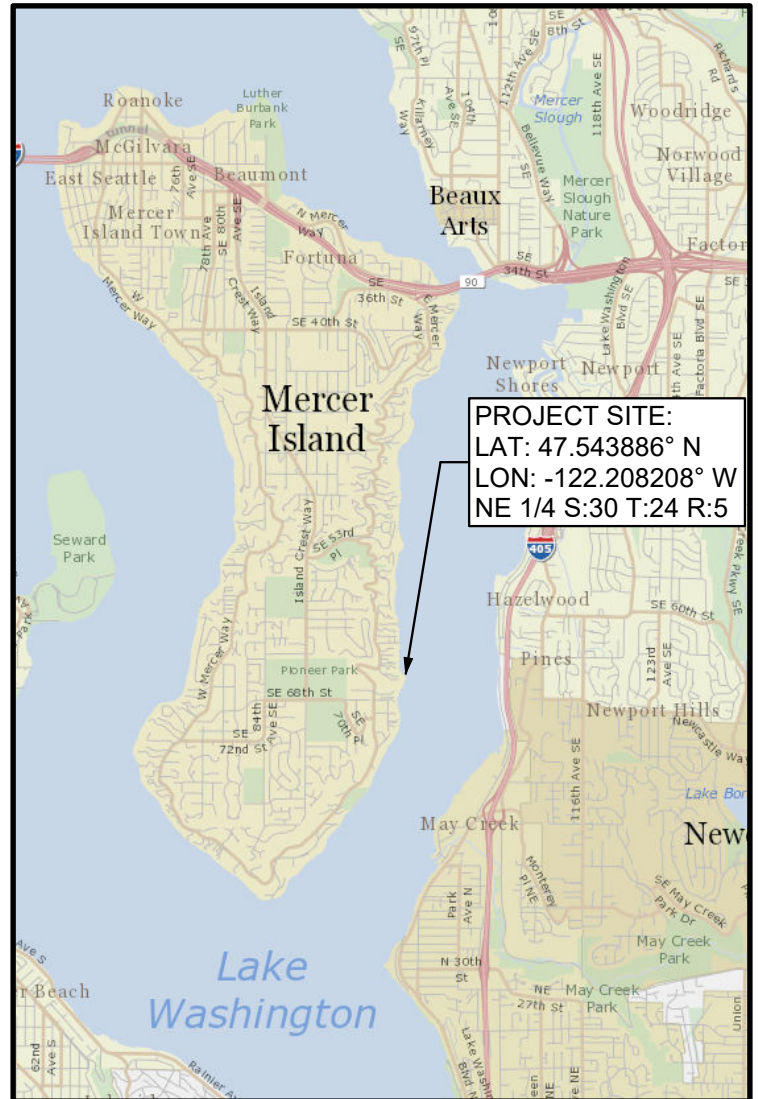

REFERENCE:

DATUM: C.O.E. Locks Datum

ADJACENT PROPERTY OWNERS:

1. Tyler & Andrea Simpson
2. Dheeraj Koneru

APPLICANT: Jack Hanover

LOCATION: 6460 E Mercer Way
Mercer Island, WA 98040

LAT/LONG: 47.543886°/-122.208208°

PROPOSED PROJECT:

Repair Pier

IN: Lake Washington

NEAR/AT: Mercer Island

COUNTY: King **STATE:** WA

SHEET 1 of 8

DATE: December 23, 2025

PLEASE NOTE THAT THE SHORELINE CONFIGURATION AND PROPERTY LINE LOCATIONS ARE APPROXIMATE ONLY. PROPERTY LINES ARE BASED ON KING COUNTY GIS.

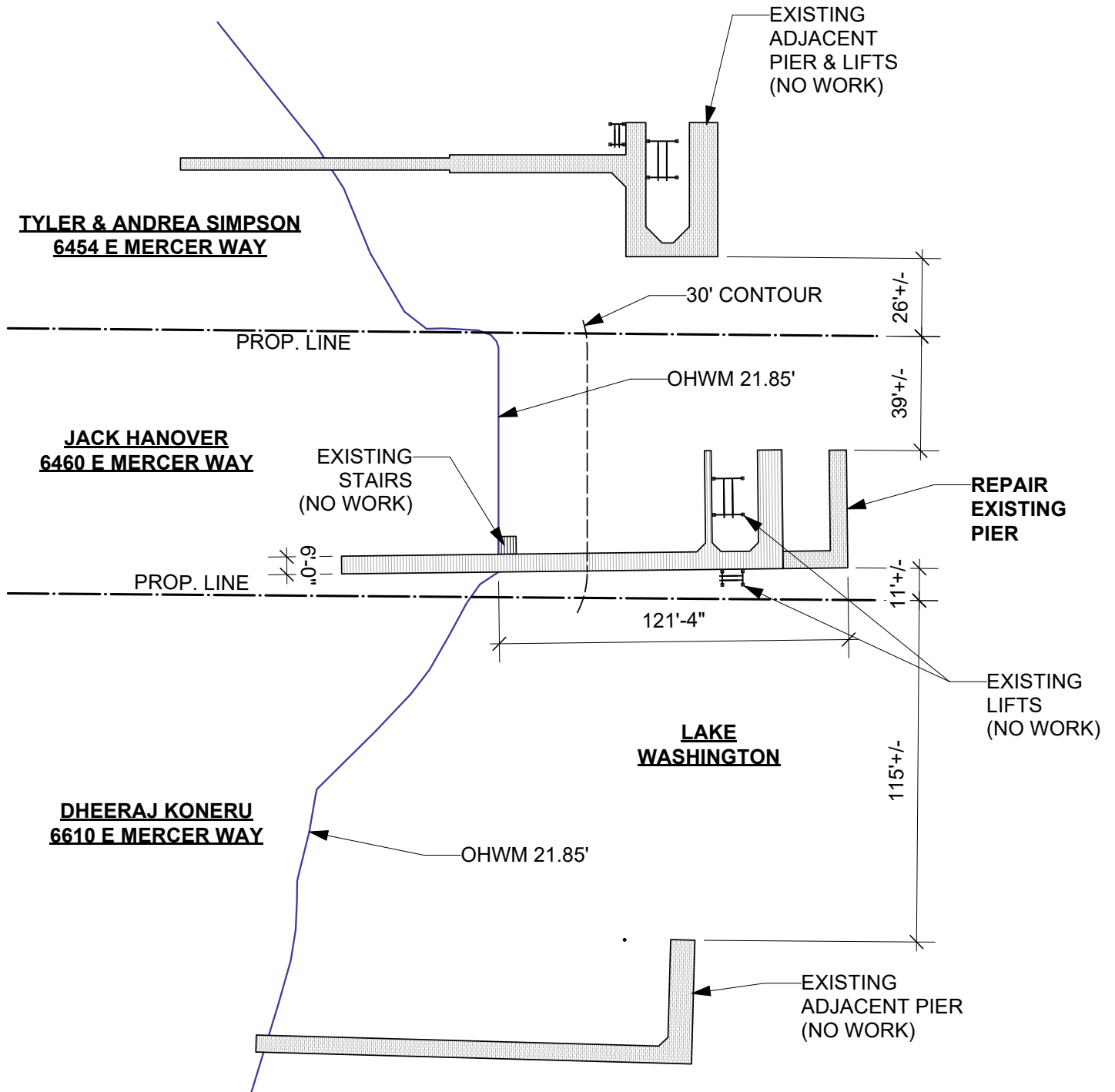

EXISTING SITE PLAN

SCALE 1" = 50'-0"

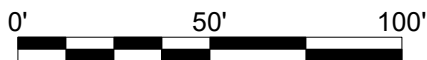

Reference:
Applicant: Jack Hanover

Proposed: Repair Pier
Location: Mercer Island, WA

PLEASE NOTE THAT THE SHORELINE CONFIGURATION AND PROPERTY LINE LOCATIONS ARE APPROXIMATE ONLY. PROPERTY LINES ARE BASED ON KING COUNTY GIS.

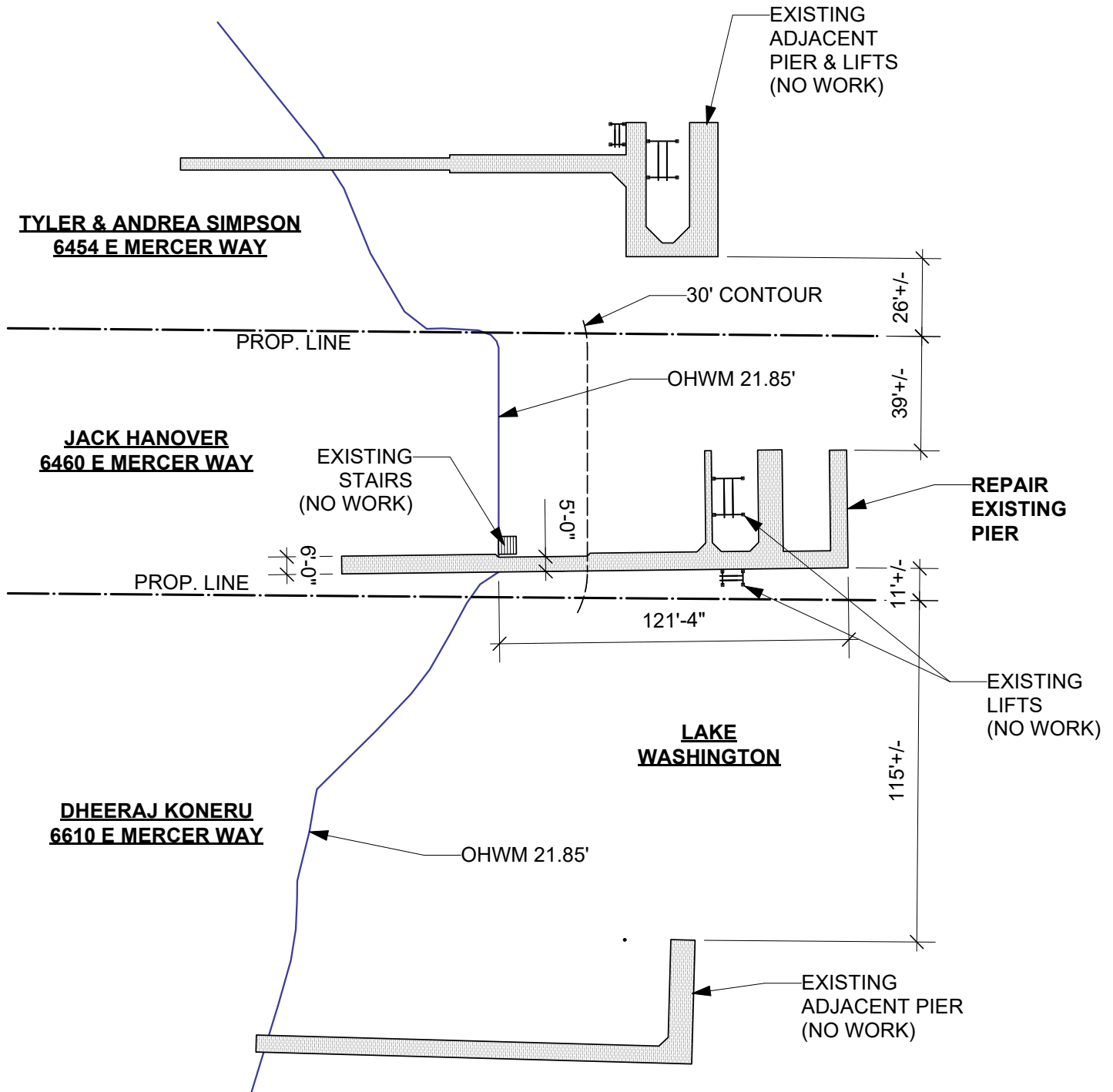

PROPOSED SITE PLAN

SCALE 1" = 50'-0"

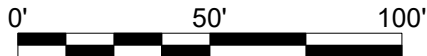

Reference:
Applicant: Jack Hanover

Proposed: Repair Pier
Location: Mercer Island, WA

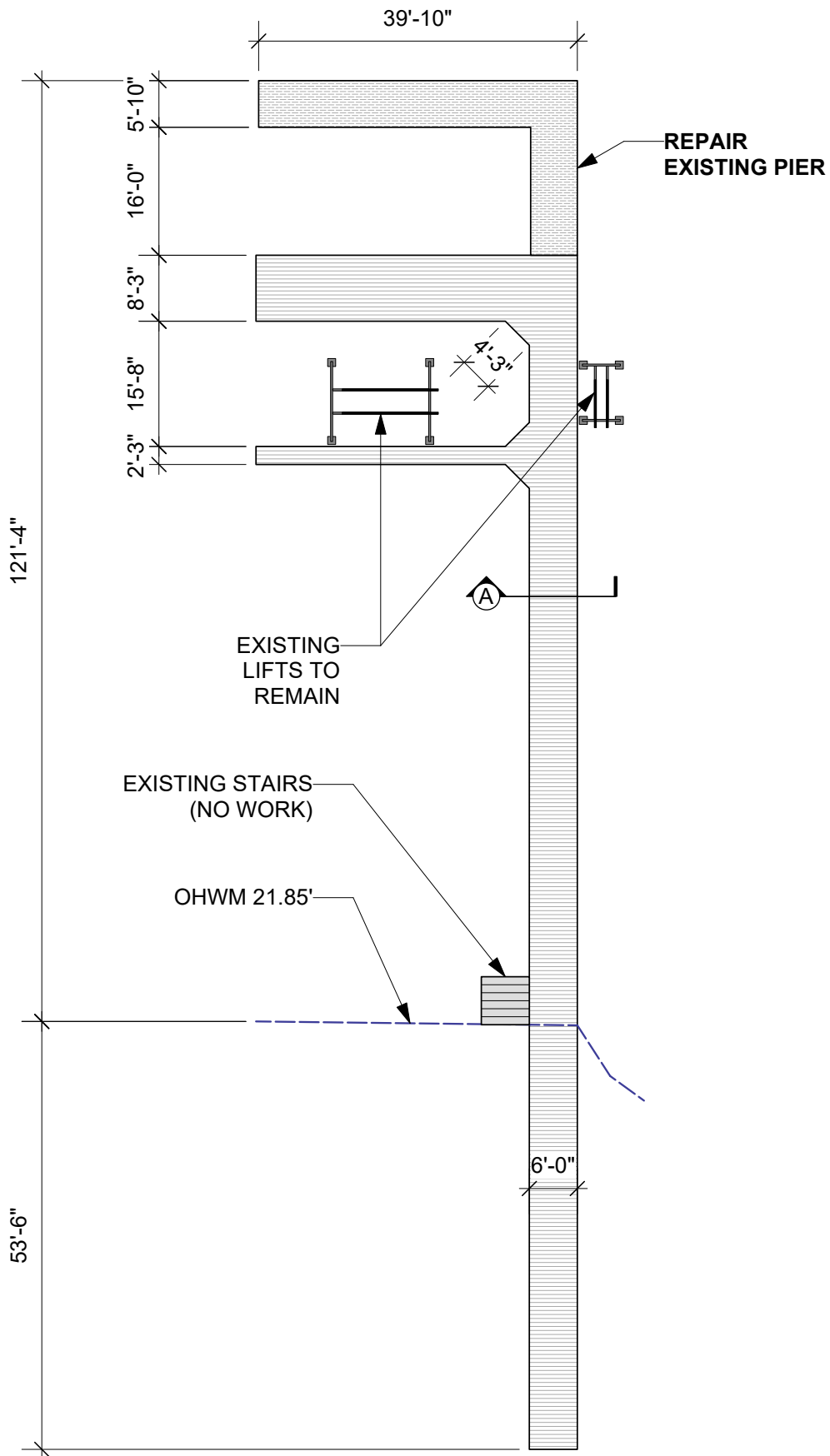

EXISTING PIER PLAN

SCALE 1" = 20'-0"

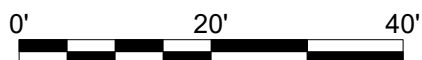

Reference:
Applicant: Jack Hanover

Proposed: Repair Pier
Location: Mercer Island, WA

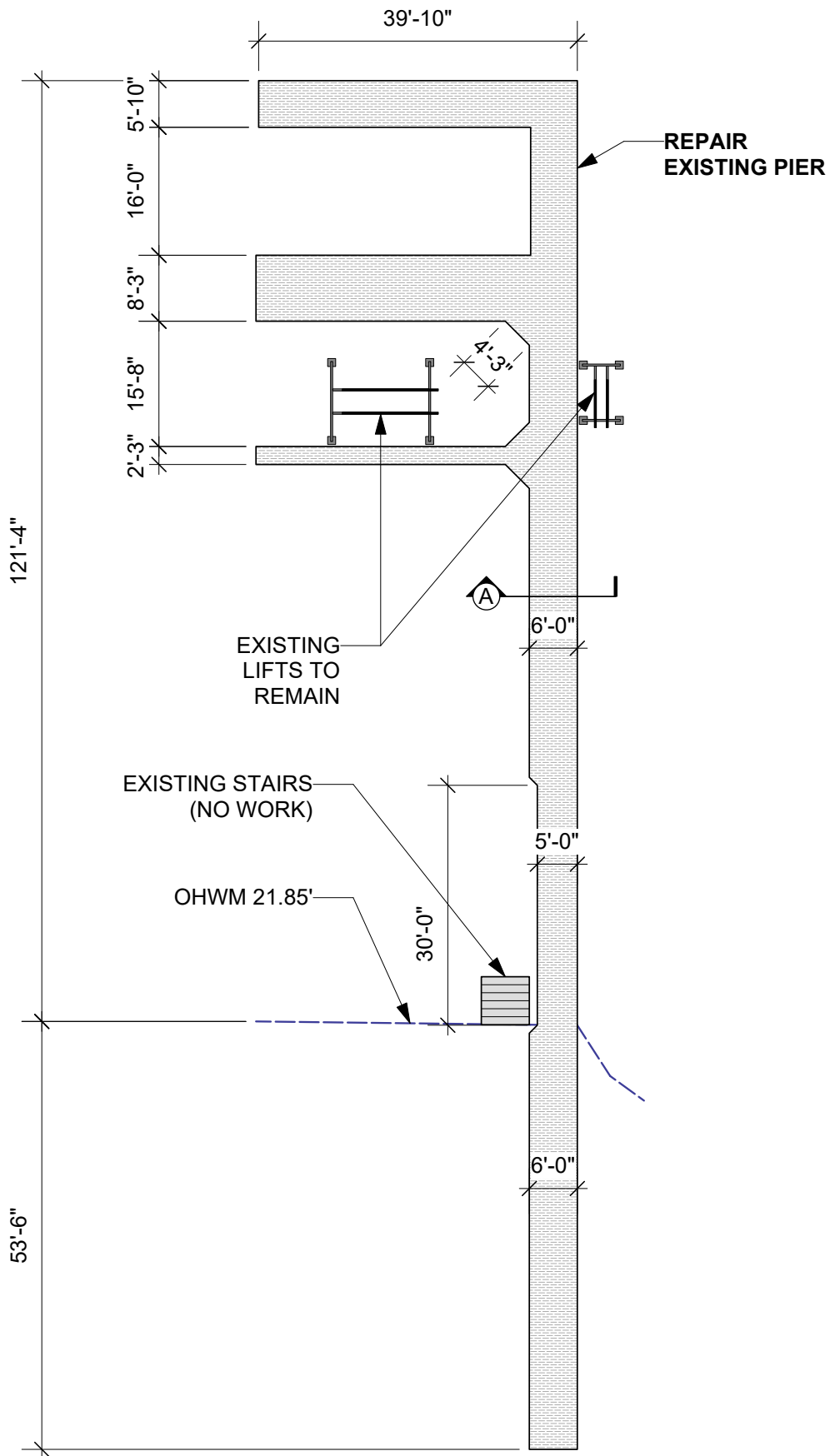

PROPOSED PIER PLAN

SCALE 1" = 20'-0"

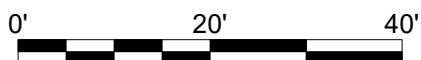

Reference:
Applicant: Jack Hanover

Proposed: Repair Pier
Location: Mercer Island, WA

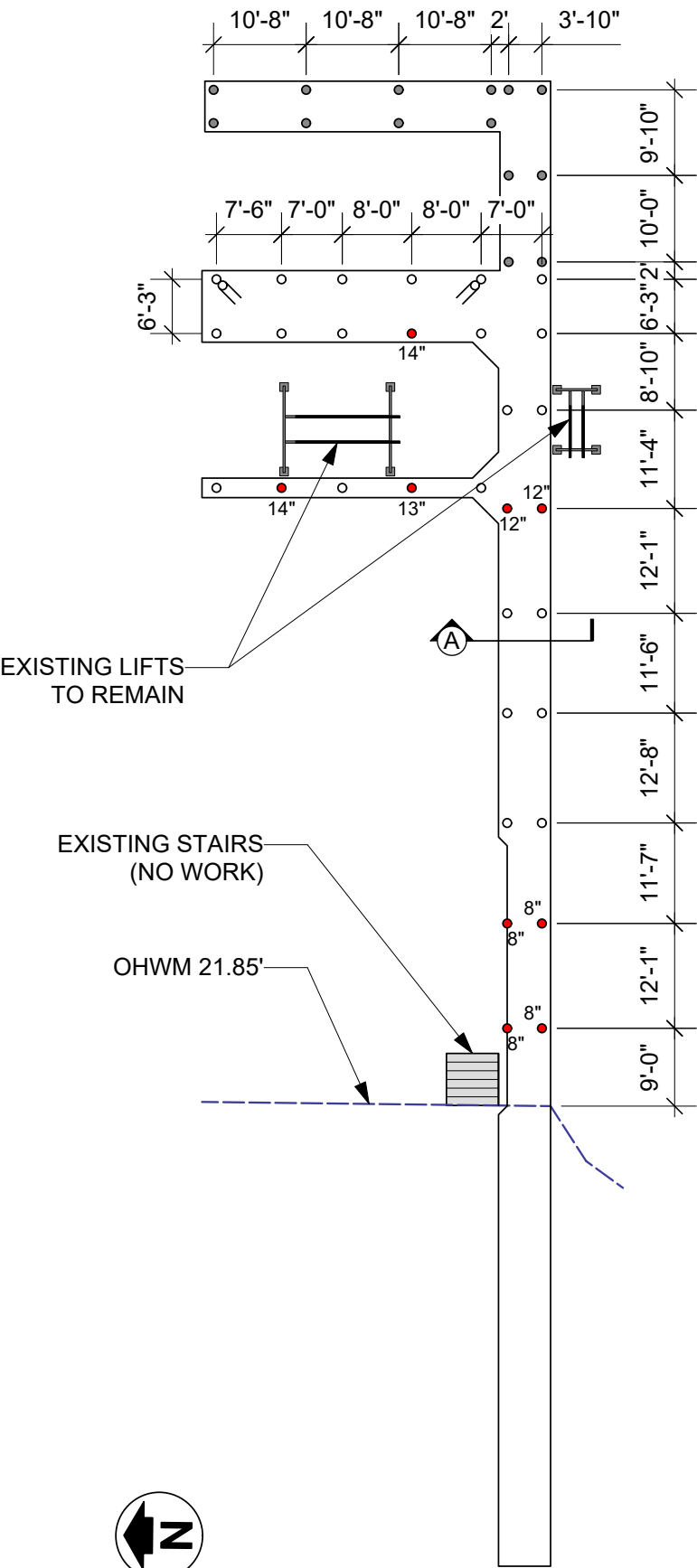

LEGEND

- EXISTING WOOD PILE TO REMAIN (24 TOTAL)
- EXISTING STEEL PILE TO REMAIN (14 TOTAL)
- EXISTING WOOD PILE TO BE SLEEVED (9 TOTAL)

PILE REPAIR PLAN

SCALE 1" = 20'-0"

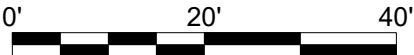

Reference:
Applicant: Jack Hanover

Proposed: Repair Pier
Location: Mercer Island, WA

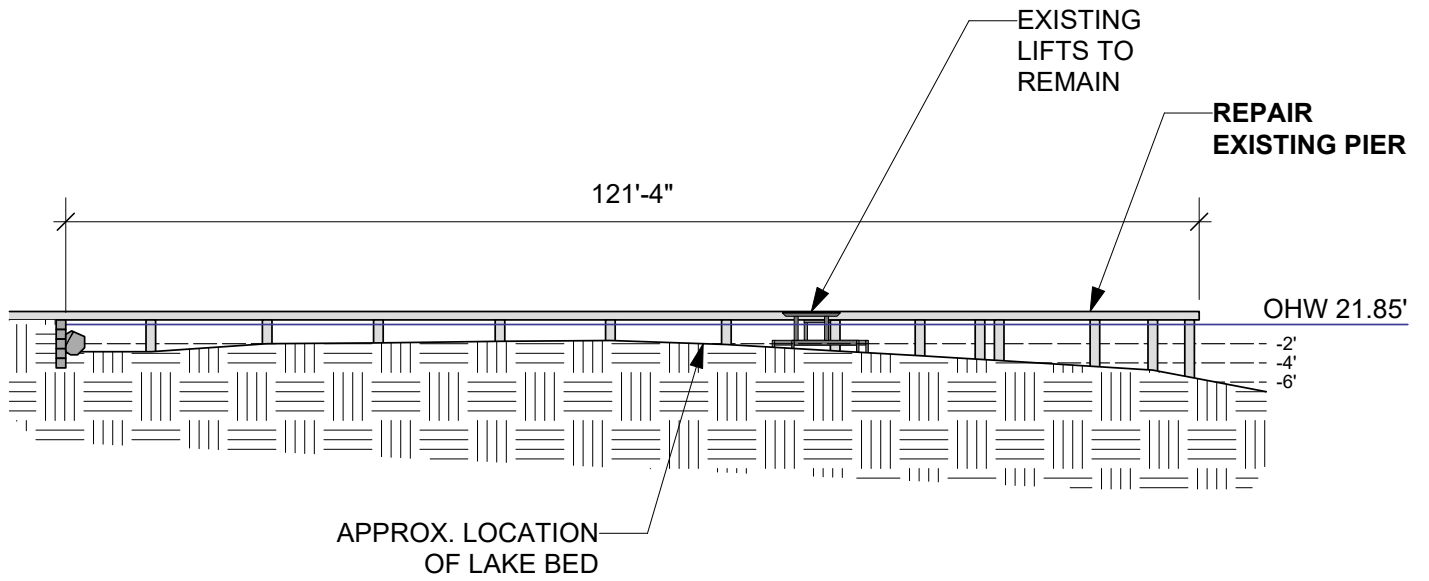

PIER ELEVATION

SCALE 1" = 20'-0"



Reference:
Applicant: Jack Hanover

Proposed: Repair Pier
Location: Mercer Island, WA

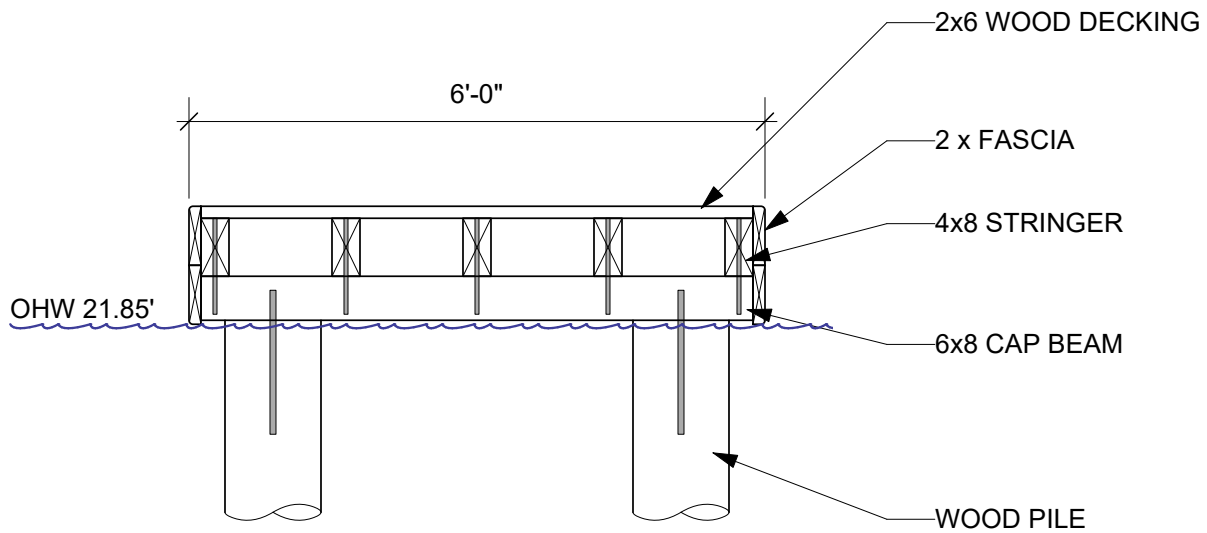

EXISTING PIER SECTION - A

SCALE 1/2" = 1'-0"



Reference:
Applicant: Jack Hanover

Proposed: Repair Pier
Location: Mercer Island, WA

Sheet 8 of 10 **Date:** 12/23/2025

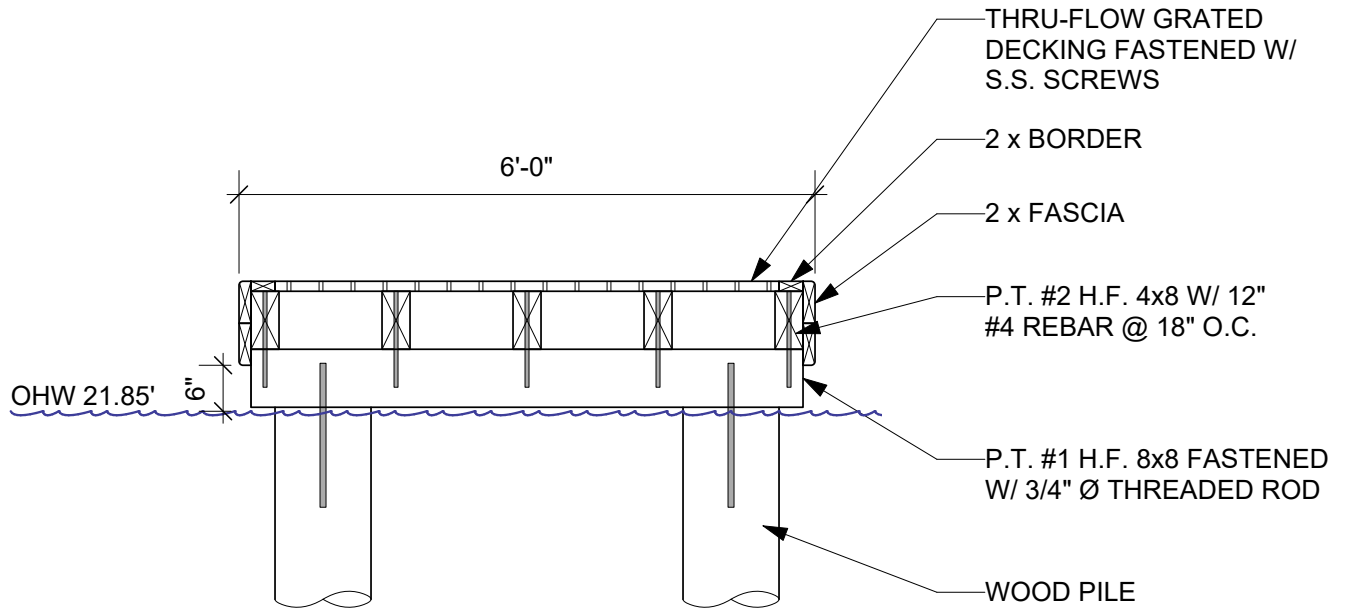

PROPOSED PIER SECTION - A

SCALE 1/2" = 1'-0"



Reference:
Applicant: Jack Hanover

Proposed: Repair Pier
Location: Mercer Island, WA

Sheet 9 of 10 **Date:** 12/23/2025

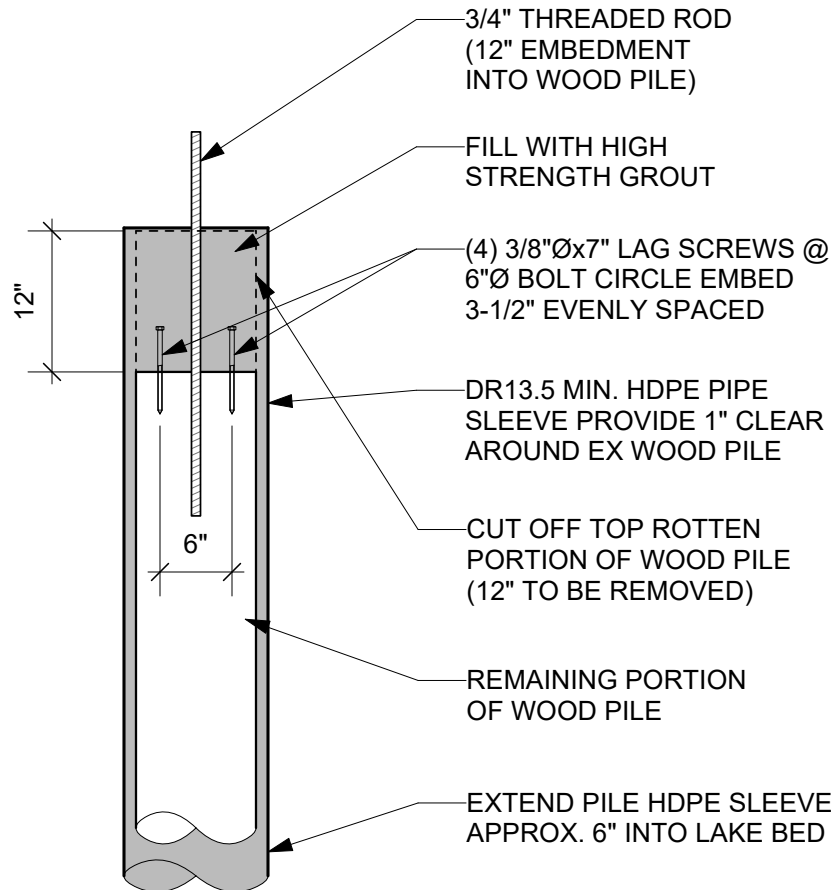

PILE SLEEVE DETAIL

SCALE 3/4" = 1'-0"



Reference:
Applicant: Jack Hanover

Proposed: Repair Pier
Location: Mercer Island, WA

Sheet 10 of 10 **Date:** 12/23/2025